

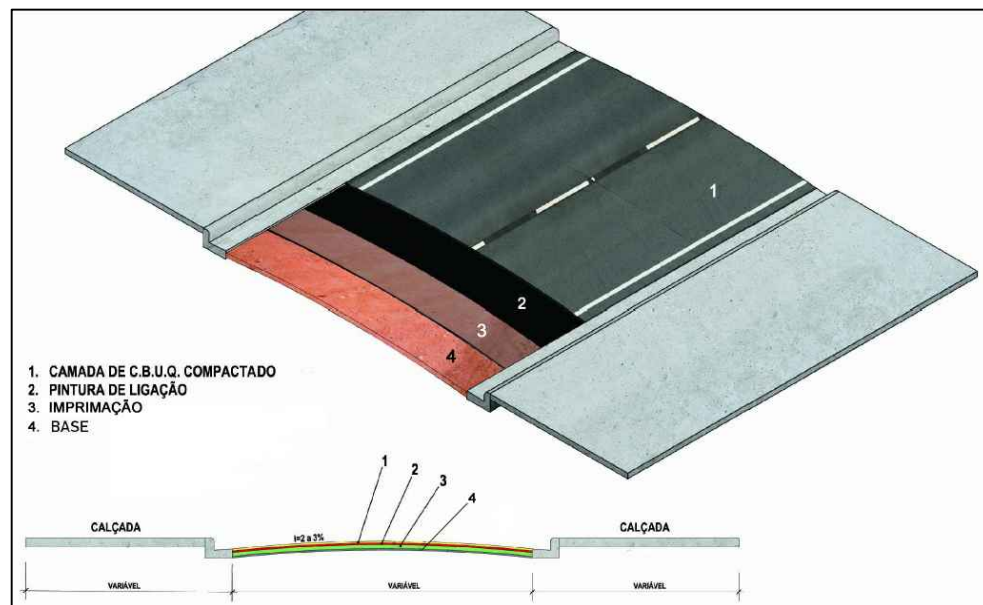

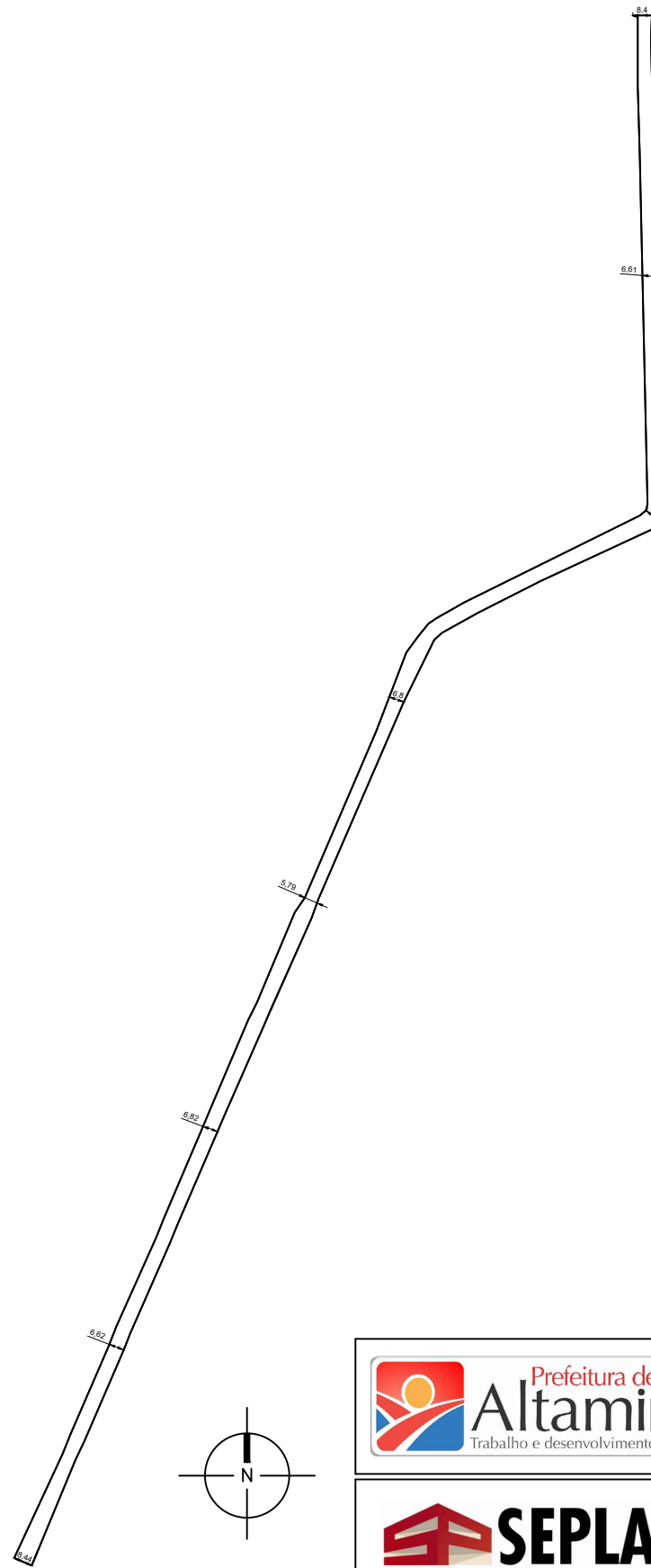

VIAS PARA PAVIMENTAÇÃO NA SEDE DO MUNICÍPIO DE ALTAMIRA - PA

ITEM	LOGRADOURO	BAIRRO	ÁREA (m ²)	PERÍMETRO (m)	EXTENSÃO (m)	LARG. MÉDIA (m)	ESPESSURA (m)	VOLUME DE CBUQ (m ³)	COORD. INICIAL	COORD. FINAL
47	RUA FRANCISCO BANDEIRA DE MATOS	SANTA BENEDITA	5.269,56	1.580,02	790,01	6,67	0,045	237,13	-3.174450°,-52.195886°	-3.168329°,-52.193429°



 Prefeitura de Altamira Trabalho e desenvolvimento social		PROJETO: RUA FRANCISCO BANDEIRA DE MATOS
 SEPLAN Secretaria Municipal de Planejamento		MUNICIPIO: ALTAMIRA - PA
		47
		PRANCHA: IMPLANTAÇÃO
		61
		ESCALA: 1/3000
		DATA: 24/03/2020